

**Congratulations** on your purchase of the **Valvin V100L** by Herring Group Inc., which is designed for the purpose of stopping toilet leak events. Upon detection of a leak, the V100L will automatically shut off the water supply to the toilet. The benefits of stopping toilet leaks can vary from a toilet open flapper leak, leaky fill valve or a silent flapper leak.

This manual will provide you with the needed information for the proper installation and operation of your new VALVIN V100L fill valve unit.

**Note:** We recommend you leave this manual or a copy accessible to the owner/user, in case quick reference is desired.

**This Package Contains:**

- A) Fill Valve with tank/leak sensor unit
- B) Clear Refill Tube
- C) Controller Box
- D) Hook & Loop Strip (controller attachment strip)

**VALVIN FILL VALVE INSTALLATION INSTRUCTION**

- 1) Turn off the water supply valve.
- 2) Flush toilet and remove remaining water from tank.
- 3) Remove the water supply hose from the bottom of the old fill valve (a). There should be no reason to remove the water supply hose at the wall shutoff valve (b).
- 4) Remove the locknut (underside of tank) and lift the old fill valve out of the tank (see the third illustration).

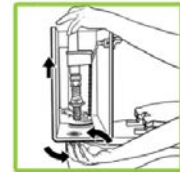
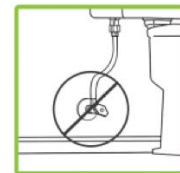

**Note:** You may need a small bucket under the fill valve unit to catch water still left in the toilet tank.

- 5) **ADJUST THE VALVIN FILL VALVE HEIGHT (see steps below):**
  - Snap free the 2 tabs on the lock tab ring (downward) as seen in the 1<sup>st</sup> of the 3 illustrations seen below, adjacent to the downward pointing arrow.
  - Rotate the lower portion of the fill valve’s shaft “clockwise” (it will rotate about 1/8 turn and stop). The upper and lower shafts will now telescope to increase or decrease for height adjustment. Determine the proper height adjustment by referencing the pre-existing fill valve’s height.
  - Rotate the lower portion of the fill valve’s shaft back “counterclockwise” to the desired height position, then snap back in place the 2 tabs on the lock tab ring (upward) as seen in the 3<sup>rd</sup> of the 3 illustrations seen below, adjacent to the upward pointing arrow.



- 6) **Installing the V100L fill valve in tank:** Recheck the height and insure that the large rubber gasket is in place at the bottom of the lower valve shaft (now remove lower stem washer and lock nut). The large rubber gasket is to be installed with the flat side up. Place the V100L fill valve in the tank, and then loosely install the lower stem washer and lock nut on underside of tank allowing for fill valve rotation.
- 7) Rotate the V100L fill valve so that the fill valve’s small nipple plastic tip (with clear refill tube) faces approximately towards the toilet’s overflow pipe and the tank/leak sensor is on the left side, also facing the overflow tube. Press down on the V100L and **HAND TIGHTEN** the lock nut on underside of tank.

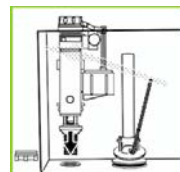

8) Place the tip of the clear refill tube into the top of the drain pipe and fasten in place with the clip. You may have to trim the length of the refill hose and allow some arch when it is connected to the top of the fill pipe.

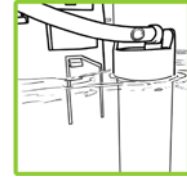

9) Reconnect the water supply hose (b) in 2<sup>nd</sup> illustration.

10) Hang the controller (with use of the hook & loop supplied) on the outside edge of the tank on a side nearest the fill valve. Move the controller to a location so the LED is visible and the reset button (identified as PRESS HERE) is accessible. If the controller is to be wall mounted, insure that the flat connecting cable is fit properly over the top edge of the tank so that it is not harmed when the tank lid is replaced.



11) Turn on the water supply valve.

12) Press down on the top of the V100L fill valve's float lever & adjustment screw to reset the latch (**Press to reset**). Please make sure under this lever that the plastic square is down and water is coming into the tank. Once water is coming into the tank, there is no need to press to reset lever again.

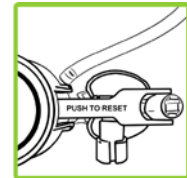

13) Turn the float lever's adjustments screw to obtain a water level that matches the desired water level and that the water lever is **at the water line mark**. **It is important the water is adjusted to this water line mark. Please flush your toilet and confirm that the water does stop again at the water line mark.**



14) Install the 9V battery in the V100L's "controller" from the bottom side.

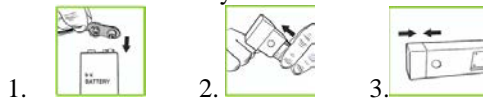

15) Press and hold the reset button (identified as PRESS HERE) on the VALVIN controller for about 1 second and see the green ready light come on. The V100L controller and fill valve is now functional and ready.

## V100L FILL VALVE OPERATING INSTRUCTIONS

The operation of the V100L is fully automatic and only requires manual resetting after an automatic shutoff event.

Your V100L controller's multi-colored LED will identify any one of following conditions:

- Open Flapper Leak (a fault)
- Silent flapper Leak (a fault)
- Low Battery (a fault)
- Fill Valve Leak (a fault)
- System Ready (status)

When any one of the faults listed above occur, the V100L trips the lifting plunger beneath the fill valve float's top lever (under the press to reset label), thereby causing the fill valve to close regardless of the water level in the bowl or tank.

The specific fault that caused the V100L to turn off the water is identified by both the color of the LED display and also by a flash code count (the number of times the LED flashes). These faults are identified by the LED once (at the time of fault) and can be seen again anytime at the "PRESS HERE" button is pressed for 1 second.

## V100L CONDITION CODES

FAULT	NO. OF FLASHES	LED COLOR	ACTION
Open Flapper	4	Orange	Flapper is stuck up, jiggle handle to reset
Silent Leak	5	White	Dirty flapper or bad flapper
Low Battery	1	Red	Replace Battery then Reset control unit.
Leaky Fill Valve	2	Purple	Fill valve diaphragm worn (replace)
System Ready	1	Green	No Action Required / Unit ready

### **IMPORTANT RESET INSTRUCTIONS** (Steps after fault detected):

- a) Determine the status of the system by pressing the reset (PRESS HERE) button on the controller (for one second) until the LED flashes.
- b) Resolve the fault that was detected. (Means to fix the problem detected)
- c) Press the reset (PRESS HERE) button for four (4) seconds to reset to the System to a Ready green light.
- d) **Remove the tank lid and press down on the fill valve's float lever until the plunger under the lever latches and stays down in place allowing water back in the tank, then replace tank's lid back on.**

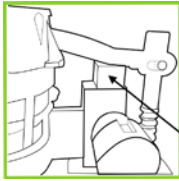

Water Off (Plunger UP)



Press down to Reset

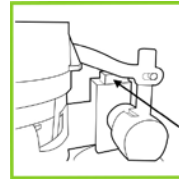

Water Back On (Push Plunger Down)

## SUMMARY OF LIMITED WARRANTY

Herring Group Inc. ("Manufacturer") warrants solely to the original purchaser (the "Buyer") of this [Valvin™ V100L] (the "Product") that the Product will be free from material defects in workmanship and materials under normal use and service for a period of 1 year from the date of purchase. There is NO WARRANTY in case of faulty maintenance, abuse, misuse, accident, or other damages; failure to follow Valvin' instructions. Improper installation (including without limitation, over-tightening, manual break wire); or other costs resulting from labor charges, delays, vandalism, negligence, fouling caused by foreign material, damage from poor water conditions, chemicals, or any other circumstances over which HGI INC. has no control. All costs of removal, transportation, and reinstallation to obtain warranty service shall be paid by the consumer.

For Further Information, please contact: [info@floodingsensors.com](mailto:info@floodingsensors.com)

